

56-62 Door Weatherstrip

ALL are made in the USA, not Gray but Black Sponge Rubber with the authentic Profile, Molded Ends and properly Cured. It will not erode away into little rubber balls if rubbed. Our prices beat everyone and we have 100% in stock, not drop shipped say, *mann-yanna*".

A Door Main Weatherstrip

53-55 LH or RH Weatherstrip	1069209	15.00
56-58 LH Door Main Weatherstrip	1069217	33.00
56-58 RH Door Main Weatherstrip	1069218	33.00
56-58 LH+RH Door Main Pair	1069249	65.95

New Door Mains with Embedded Plastic Pins for attaching the weatherstrip to the mounting holes in the perimeter of the door fiberglass. These do not include metal door post attaching clips - NONE DO. See Clip this page.

59-60 LH Door Main Weatherstrip	1069211	40.50
59-60 RH Door Main Weatherstrip	1069212	40.50
59-60 LH+RH Door Main Pair	1069250	80.95
61-62 LH Door Main Weatherstrip	1069213	48.25
61-62 RH Door Main Weatherstrip	1069214	48.25
61-62 LH+RH Door Main Pair	1069251	96.00

B Auxiliary Door Weatherstrip

Early 59 is before April 27, 1959 production date approx. VIN # 6300. *Late 59* is after VIN # 6300.

56- <i>Early</i> -59 Door Replacement Aux Pair	1069258	30.00
<i>Late</i> 59-62 Replacement Auxiliary Pair	1069259	32.50
New authentic design Soft Sponge Rubber with a skin on the surface, Not Foam rubber or solid rubber like others.		
56- <i>Early</i> -59 Door Authentic Auxiliary Pair	1069421	30.95
<i>Late</i> 59-62 Door Authentic Auxiliary Pair	1069422	33.95

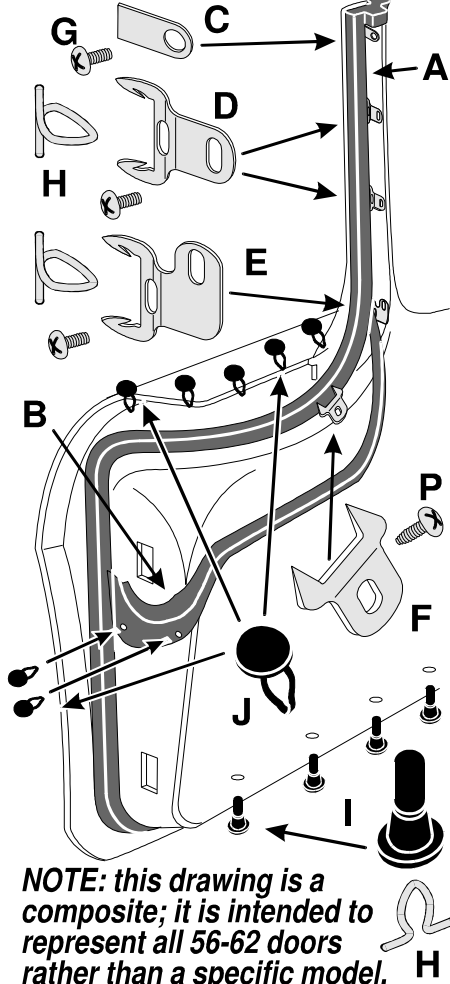

NOTE: this drawing is a composite; it is intended to represent all 56-62 doors rather than a specific model.

Mounting Hardware

You asked for 'em.. we made 'em Right Authentic design Door Post Clips made from Dull Stainless Steel, not shiny with the authentic Offset, not a flat replacement plus the Sharp Barbs necessary for mounting

Psssst... there is another source for these clips, but it's an incomplete imitation. Don't worry about the sharp Fish Hook Barbs on their clips - They Don't Have Em! How do they grab the wire clips? I guess they don't. Ours grab both factory weatherstrips and repro's that have been properly wire mounted. See NRCS.org tech message 122304 for details. I would not expect this from the Leader in Corvette Parts - they Stink perhaps they are not the Leader in Corvette Parts.

Caution

Parts D and E described below have very sharp mounting Barbs. Handle them very carefully to prevent getting cut. Treat them with the same respect as you would treat the similar sharp barbs on a Fish Hook. Disregard this notice if you got BRAND Z.

None of the 59-62 door weatherstrips that are available or manufactured by us (or Anyone else) have these metal clips installed. These clips allow you to install door weatherstrip just like GM.

C 59-60 Upper Door Post Clip

This clip is not completely authentic in design, because the GM clip is a complex design that is completely molded into the rubber at the top of the weatherstrip. Our clip replicates the actual exposed area & can be installed by making a small slit in the weatherstrip. Once installed it is undetectable, since only the part with the mounting hole is exposed. 2 reqd per car. Available in a kit with the other clips on the next page. 1065960 4.00

D 59-62 Middle Door Post Clip

This clip is completely authentic in design down to the thousandth of an inch. The oval slot nearest the BARBS accepts the weatherstrip mounting wires. 4 reqd per car. Available in a kit on the next page. 1065962 6.00

E 59-62 Lower Door Post Clip

This clip is completely authentic in design down to the thousandth of an inch. The oval slot nearest the BARBS accepts the weatherstrip mounting wires. 1 LH and 1 RH required per car for the front door post on 59-62. Available in a kit with the other clips on the next page.

59-62 LH Door Post Clip	1065964	6.00
59-62 RH Door Post Clip	1065966	6.00

F Late 62 Door Post Clip

This clip is Zinc plated steel without the sharp barbs as factory. 4 reqd per car. Available in a kit with the other clips on the next page. 1065968 3.50

G 59-62 Door Post Clip Mtg Screws

16 Piece set. Does 1 car. 1071018 5.75

H 59-62 Weatherstrip Wire Fastener

These wire type clips slip into the mounting holes along the edges of the of the doors. Although the factory wires were embedded in the rubber, our uniquely designed wire fastener allows an authentic appearance after installation. 59-60 Door 54 Piece Weatherstrip Wire Fastener Kit Does 1 car. 1069200 0.00
61-62 Door 40 Piece Weatherstrip Wire Fastener Kit Does 1 car. 1069202 0.00

I 59-62 W/S Mounting Hole Retainer

These tubular plastic parts snap into the mounting holes around the edges of the door. They have internal radial partitions like the spokes in a wheel that help prevent the weatherstrip from twisting after installation.. 59-60 Weatherstrip Plug 54 Piece Set 1069198 12.50
61-62 Weatherstrip Plug 40 Piece Set 1069199 10.50

J Steel Push-In W/S Fastener

Authentic Black Steel Push-in Style fastener. 56-58 Door Main Weatherstrip 18 Piece Set Use 5 on the front & 4 on the rear of each door. Does 1 car 1069210 8.95
56-62 Auxiliary Door Weatherstrip 4 Piece Set Does 1 car 1069419 3.95

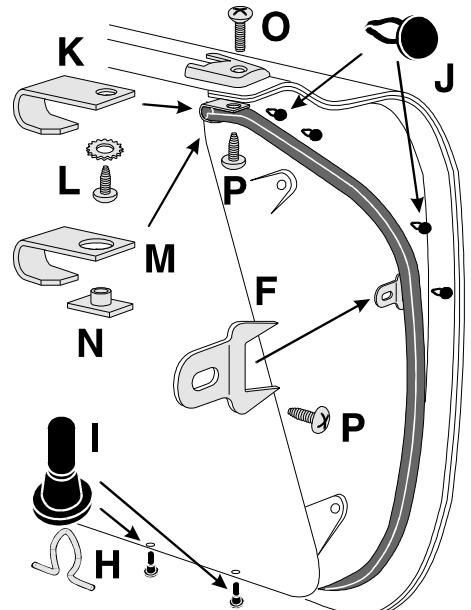

NOTE: this drawing is a composite; it is intended to represent all 56-62 doors rather than a specific model.

K 56-57 Rear Weatherstrip Retainer

These authentic thickness Stainless steel retainers fold over the rear end of the door weatherstrip when installed Pair Does 1 car. See TIP below. 1069423 5.00

L 56-57 Retainer 4 Piece Mounting Kit

With 2 screws & star washers required to install the above clips. Does 1 car. 1069424 2.75

M 58-60 Rear Weatherstrip Retainer

These Stainless steel retainers fold over the rear end of the weatherstrip when installed. They are the authentic thickness for easy installation. Pair Does 1 car. See TIP below. 1069425 5.00

N 58-62 Retainer "T" Nuts

Mounts the retainers & the door end caps. NOS GM - Not cheepo repro. Pair Does 1 car. 1071028 7.50

O 58-62 Retainer Mounting Screws

Chrome plated pair, also mounts the door end caps. Does 1 car. 1071029 1.90

P 61-62 Rear W/S & Clip Mount 4 Piece Set

Mounts the rear molded weatherstrips end & the rear door weatherstrips mtg clips or the front lower door weatherstrips mtg clips. 2 reqd. 1069426 2.50

56-60 Installation Tip

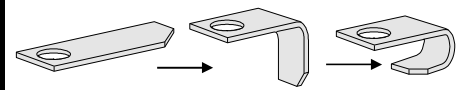

The 56-57 and 58-60 Rear Weatherstrip Clip Retainers (parts J and L) are supplied flat and must be bent to the shape shown above. We suggest that you perform the bending prior to installation. Mount them in a vice and bend over a small round pipe or screwdriver shaft. Once installed, bend further to get a snug fit.